

Whitworth

*Building the
future...*



A three bedroomed semi-detached house.

An elegantly designed home, including entrance hall, downstairs cloakroom, lounge, dining/kitchen and bathroom.

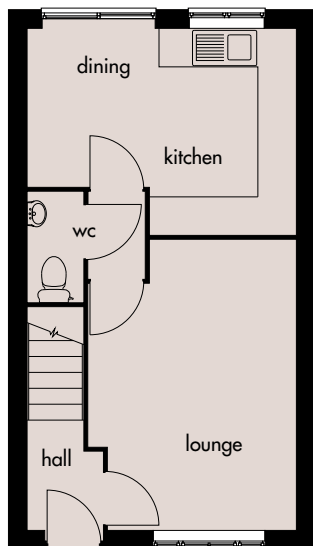

Ground Floor

Lounge: 4490mm x 3200mm(max)
14'8" x 10'5"(max)
Kitchen/Dining: 4165mm x 3210mm(max)
13'7" x 10'6"(max)

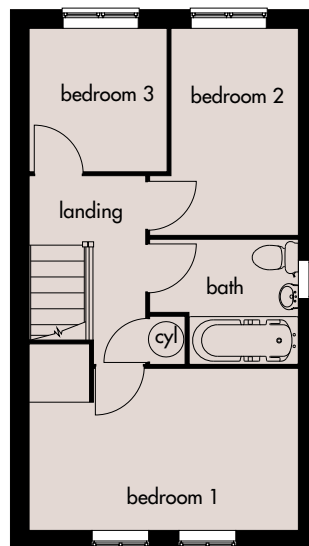

First Floor

Bedroom 1: 4165mm x 2480mm(max)
13'7" x 8'1"(max)
Bedroom 2: 3170mm x 1970mm
10'4" x 6'5"
Bedroom 3: 2230mm x 2100mm
7'3" x 6'10"

Broseley Homes Limited, Investor House,
Colima Ave, Sunderland Enterprise Park,
Tyne & Wear SR5 3XB
Tel: 0191 5370980
www.broseley-homes.co.uk



Type 366 (13-01-06)

Broseley Homes Limited, Falcon House,
Preston Farm Park,
Stockton-on-Tees TS17 3TS
Tel: 01642 499700
www.broseley-homes.co.uk