

Rockwell 'G'

Designs for living...



A four bedroomed detached house.

An elegantly designed home, including double integral garage, entrance hall, downstairs cloakroom, lounge, dining room, kitchen, utility, bathroom and en-suite to master bedroom.

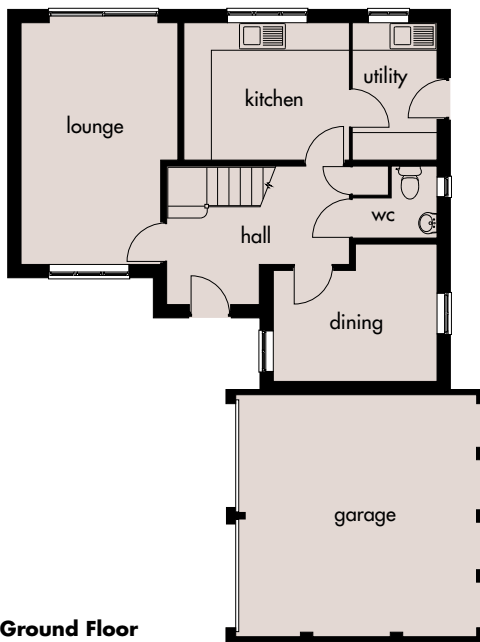

Ground Floor

Lounge:	5250mm x 3400mm 17'2" x 11'1"
Kitchen:	3570mm x 2975mm(max) 11'8" x 9'9" (max)
Utility:	2975mm x 1830mm 9'9" x 6'0"
Dining:	3550mm x 2975mm 11'7" x 9'9"

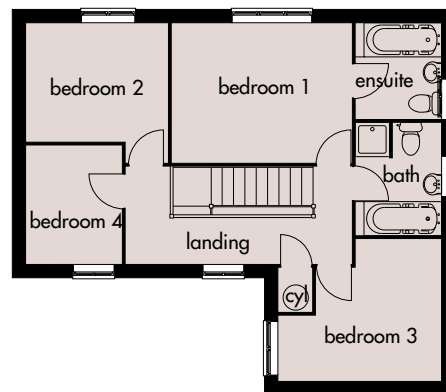

First Floor

Bedroom 1:	3910mm x 3025mm(max) 12'9" x 9'11" (max)
Bedroom 2:	3085mm x 3025mm 10'1" x 9'11"
Bedroom 3:	3550mm x 3035mm(max) 11'7" x 9'11" (max)
Bedroom 4:	2575mm x 2080mm 8'5" x 6'9"
Ensuite:	2080mm x 1855mm 6'9" x 6'1"

Broseley Homes Limited, Investor House,
Colima Ave, Sunderland Enterprise Park,
Tyne & Wear SR5 3XB
Tel: 0191 5370980
www.broseley-homes.co.uk



Type 416G (13-01-06)

Broseley Homes Limited, Falcon House,
Preston Farm Park,
Stockton-on-Tees TS17 3TS
Tel: 01642 499700
www.broseley-homes.co.uk