

Meteor

*Setting the
standard...*



A two bedroomed semi-detached or mews house.

An elegantly designed home, including entrance hall, downstairs cloakroom, lounge, kitchen/dining room and bathroom.

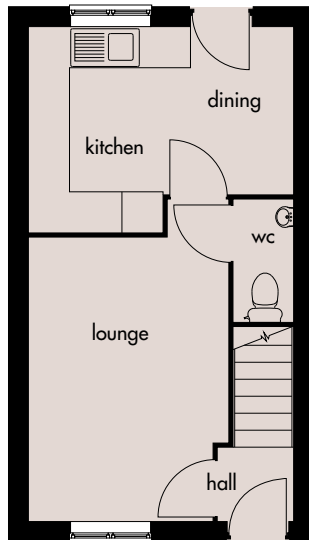

Ground Floor

Lounge: 4105mm x 2880mm
13'5" x 9'5"
Kitchen/Dining: 3840mm x 2995mm(max)
12'7" x 9'9"(max)

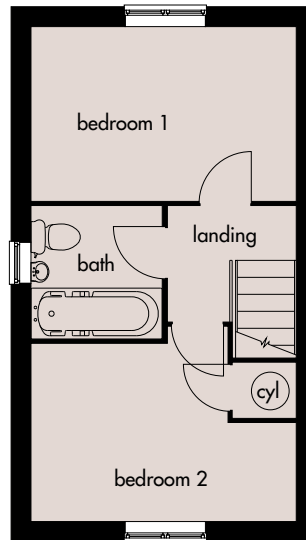

First Floor

Bedroom 1: 3840mm x 2495mm
12'7" x 8'2"
Bedroom 2: 3840mm x 2420mm(max)
12'7" x 7'11"(max)

Broseley Homes Limited, Investor House,
Colima Ave, Sunderland Enterprise Park,
Tyne & Wear SR5 3XB
Tel: 0191 5370980
www.broseley-homes.co.uk



Type 255 (13-01-06)

Broseley Homes Limited, Falcon House,
Preston Farm Park,
Stockton-on-Tees TS17 3TS
Tel: 01642 499700
www.broseley-homes.co.uk