

# Hawker

*Building  
excellence...*



## **A three bedroomed detached house.**

An elegantly designed home, including integral garage, entrance hall, downstairs cloakroom, lounge/dining room, kitchen, bathroom and en-suite to master bedroom.

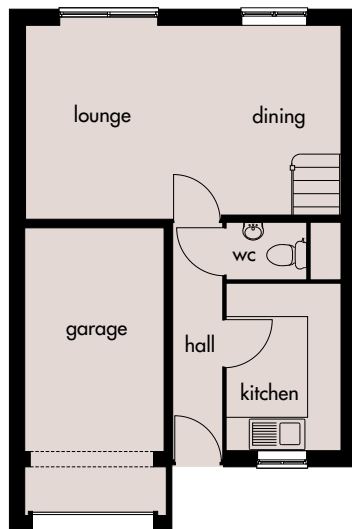

### **Ground Floor**

Lounge/Dining: 5650mm x 3415mm(max)  
18'6" x 11'2"(max)

Kitchen: 3007mm x 2020mm  
9'10" x 6'7"

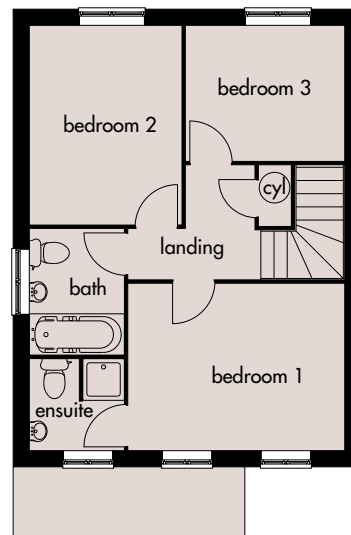

### **First Floor**

Bedroom 1: 3850mm x 3005mm  
12'7" x 9'10"

Bedroom 2: 3535mm x 2730mm  
11'7" x 8'11"

Bedroom 3: 2820mm x 2400mm  
9'3" x 7'10"

Ensuite: 1700mm x 1650mm  
5'6" x 5'4"

Broseley Homes Limited, Investor House,  
Colima Ave, Sunderland Enterprise Park,  
Tyne & Wear SR5 3XB  
Tel: 0191 5370980  
[www.broseley-homes.co.uk](http://www.broseley-homes.co.uk)



Type 376 (13-01-06)

Broseley Homes Limited, Falcon House,  
Preston Farm Park,  
Stockton-on-Tees TS17 3TS  
Tel: 01642 499700  
[www.broseley-homes.co.uk](http://www.broseley-homes.co.uk)