

# Handley

*Builders for generations...*



## A three bedroomed detached house.

An elegantly designed home, including integral garage, entrance hall, downstairs cloakroom, lounge, dining/kitchen, bathroom and en-suite to master bedroom.

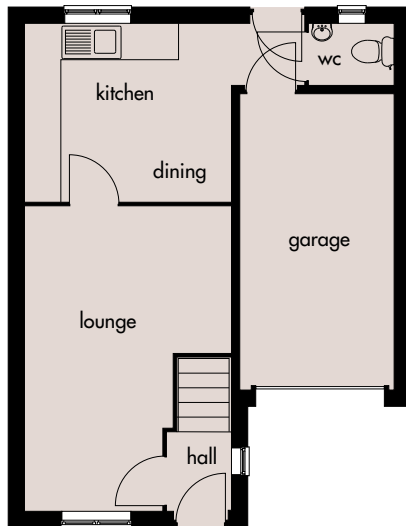

### Ground Floor

Lounge: 5105mm x 3450mm(max)  
16'8" x 11'3"(max)  
Kitchen/Dining: 3450mm x 2995mm  
11'3" x 9'9"

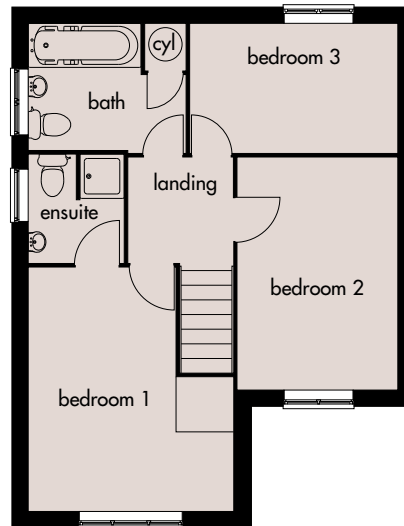

### First Floor

Bedroom 1: 4100mm x 3450mm(max)  
13'5" x 11'3"(max)  
Bedroom 2: 3880mm x 2640mm  
12'8" x 8'7"  
Bedroom 3: 3560mm x 2170mm  
11'8" x 7'1"  
Ensuite: 1750mm x 1540mm  
5'8" x 5'0"

Broseley Homes Limited, Investor House,  
Colima Ave, Sunderland Enterprise Park,  
Tyne & Wear SR5 3XB  
Tel: 0191 5370980  
www.broseley-homes.co.uk



Broseley Homes Limited, Falcon House,  
Preston Farm Park,  
Stockton-on-Tees TS17 3TS  
Tel: 01642 499700  
www.broseley-homes.co.uk

Type 371 (13-01-06)