

Halifax

Quality with style...



A three bedroomed semi-detached house.

An elegantly designed home, including integral garage, entrance hall, downstairs cloakroom, lounge, dining/kitchen and bathroom.

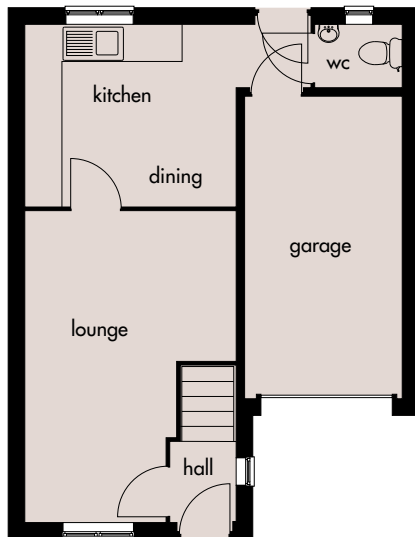

Ground Floor

Lounge: 5105mm x 3450mm(max)
16'8" x 11'3"(max)

Kitchen/Dining: 3450mm x 2995mm
11'3" x 9'9"

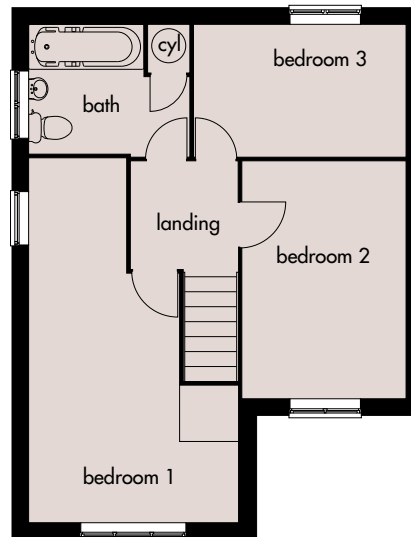

First Floor

Bedroom 1: 5945mm x 3450mm(max)
19'6" x 11'3"(max)

Bedroom 2: 3880mm x 2640mm
12'8" x 8'7"

Bedroom 3: 3560mm x 2170mm
11'8" x 7'1"

Broseley Homes Limited, Investor House,
Colima Ave, Sunderland Enterprise Park,
Tyne & Wear SR5 3XB
Tel: 0191 5370980
www.broseley-homes.co.uk



Type 369 (13-01-06)

Broseley Homes Limited, Falcon House,
Preston Farm Park,
Stockton-on-Tees TS17 3TS
Tel: 01642 499700
www.broseley-homes.co.uk